

## ISS-06-LCxx-00-0000-xx-04-xxxx

### Description

Splice module, single size, Base-2, front 06 x LCD adaptor, rear OS2/OM3/OM4; Splice protectors :heat-shrink/sandwich

#### Features

- 6 x LC duplex splicing (12 fibers)
- Fast splicing and reduced coiling time
- Lid with fiber identification
- Quick access to fiber
- Quick fix cable fixation for incoming cables
- Compact and robust plastic construction
- Bend radius control throughout (min. 30mm)
- Integrated fiber splicing cassette with integral heat shrink or sandwich splice comb
- Available in Single mode OS2 and Multimode OM3, OM4 performance
- Compatible with all IANOS chassis
- Colour coded LC adaptors
- Supplied with heat shrink or sandwich splice protectors



### Technical data

#### Mechanical data

Characteristics	Value
Product family	IANOS
Suitable for	All IANOS chassis
Width (mm)	96.7
Length (mm)	190.1
Height (mm)	11.9
Width (inch)	3.8
Length (inch)	7.5
Height (inch)	0.5
Weight (kg)	0.280
Weight (lbs)	0.618
Material	PC / ABS
Color	Black (RAL 9005)
Number of adaptors front (pcs)	6
Adaptor type	front: 6x LC-duplex rear: cable fixation
Adaptor color	front: Blue (SM/PC) Green (SM/APC) Turquoise (MM/OM3) Heather violet (MM/OM4) rear: n/a
Ferrule material LC	zirconia ceramic
Cable entry fixation	Cable fixation for 1 x 5mm. 1 x 3.6mm. 1 x 3.0mm. 1 x 2.0mm diameter cables, tie-off for cables up to 5mm Strength member retention fixations x3

#### Optical data

Characteristics	Value
Fiber count	12
Fiber type	Singlemode 9/125 µm OS2 Multimode 50/125 µm OM3 Multimode 50/125 µm OM4

## ISS-06-LCxx-00-0000-xx-04-xxxx

Module insertion loss	SM OS2: $\leq 0.50$ dB
	MM OM3: $\leq 0.25$ dB
	MM OM4: $\leq 0.15$ dB
Module return loss	SM OS2 PC: $\geq 50$ dB
	SM OS2 APC: $\geq 60$ dB
	MM OM3: $\geq 30$ dB
	MM OM4: $\geq 30$ dB

### Environmental data

Characteristics	Value
Free of halogen	yes
RoHS compliant	yes
REACH compliant	yes

### Technical drawing

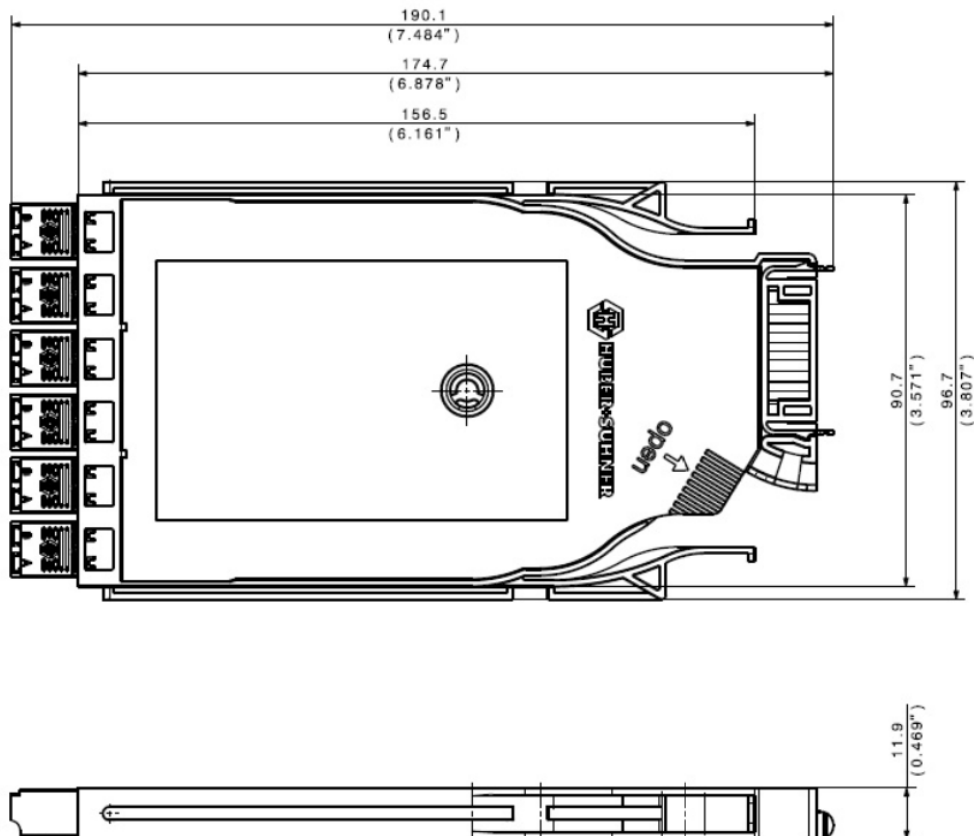

**ISS-06-LCxx-00-0000-xx-04-xxxx**

## Ordering information

---

Description	Item number
Splice module, single size, Base-2, front 06 x LCD adaptor blue (PC), rear OS2, splice protectors: heat-shrink	85115852
Splice module, single size, Base-2, front 06 x LCD adaptor blue (PC), rear OS2, splice protectors: sandwich	85115851
Splice module, single size, Base-2, front 06 x LCD adaptor green (APC), rear OS2, splice protectors: heat-shrink	85115854
Splice module, single size, Base-2, front 06 x LCD adaptor green (APC), rear OS2, splice protectors: sandwich	85115853
Splice module, single size, Base-2, front 06 x LCD adaptor turquoise (PC), rear OM3, splice protectors: heat-shrink	85115848
Splice module, single size, Base-2, front 06 x LCD adaptor turquoise (PC), rear OM3, splice protectors: sandwich	85115847
Splice module, single size, Base-2, front 06 x LCD adaptor heather violet (PC), rear OM4, splice protectors: heat-shrink	85115850
Splice module, single size, Base-2, front 06 x LCD adaptor heather violet (PC), rear OM4, splice protectors: sandwich	85115849

---

## Related documents

---

Installation manual      DOC-0000765314